

Nature²[®] Fusion Inground Vessel Assembly Replacement Kit

WARNING

FOR YOUR SAFETY - This product must be installed and serviced by a contractor who is licensed and qualified in pool equipment by the jurisdiction in which the product will be installed where such state or local requirements exist. In the event no such state or local requirement exists, the maintainer must be a professional with sufficient experience in pool equipment installation and maintenance so that all of the instructions in this manual can be followed exactly. Before installing this product, read and follow all warning notices and instructions that accompany this product. Failure to follow warning notices and instructions may result in property damage, personal injury, or death. Improper installation and/or operation will void the warranty.

Improper installation and/or operation can create unwanted electrical hazard which can cause serious injury, property damage, or death.

These instructions are to be used with the following Replacement Kit:

R0501600 -- Nature² Fusion Inground Vessel Assembly Replacement Kit

This document gives instructions for installing the Nature² Fusion inground Vessel assembly.

For technical assistance, please contact our Technical Support Department at (800) 822-7933.

All of the instructions must be followed exactly. Read through these instructions completely before starting the procedure.

CAUTION

To avoid personal injury when working with pool chemicals, always wear rubber gloves and eye protection, cover exposed skin, and work in a well ventilated area. Use caution when choosing a location to open and use chemicals as they may damage any surface into which they come in contact. If any chemical gets on your skin, rinse the area immediately with water. If any chemical gets on your clothing, immediately remove the piece of clothing and rinse with water.

1. Removal of the Nature²[®] Fusion Inground Vessel Assembly

1. Turn on the filter pump and run for five (5) minutes in order to purge the concentrated chlorine water from vessel.

WARNING

Always turn pump off prior to installing or removing any components from the pool's plumbing. Your pump/filter system is operated under pressure and pressure must be released before you begin to avoid system damage or personal injury. Open the air relief valve on your pool filter to release the pressure in the system.

2. Shut off the pool pump and filter.
3. Unscrew universal union nuts from the inlet and outlet ports of the vessel. Make sure nuts clear the thread on vessel.
4. If the vessel is anchored to the equipment pad, remove screws and washers that secure the vessel. Save the screws and washers for reinstallation.
5. Remove vessel from plumbing.
6. Remove the O-rings from the inlet and outlet tail piece. Save the O-rings for reinstallation.
7. Remove the tab feeder assembly and Nature² cartridge from the vessel by removing the handle, then unscrewing the collar, and lifting out the chlorine tab feeder body. Remove the o-ring from the vessel and save for reinstallation. If there are chlorine tablets left in the tab feeder body, remove the body carefully.



8. Remove the Nature2 cartridge from the assembly by unscrewing the collar, lifting the cartridge out and place the cartridge to the side for reinstallation. Remove the o-ring from the vessel and save for reinstallation.

2. Installation of the new Nature2® Fusion Inground Vessel Assembly

1. Make sure the pool pump is turned off.
2. If anchoring is required, manually snap on the two (2) clip-type anchor bracket onto the side feet of the vessel. Make sure these anchor brackets are attached firmly to the feet of the vessel. See Figure 1.

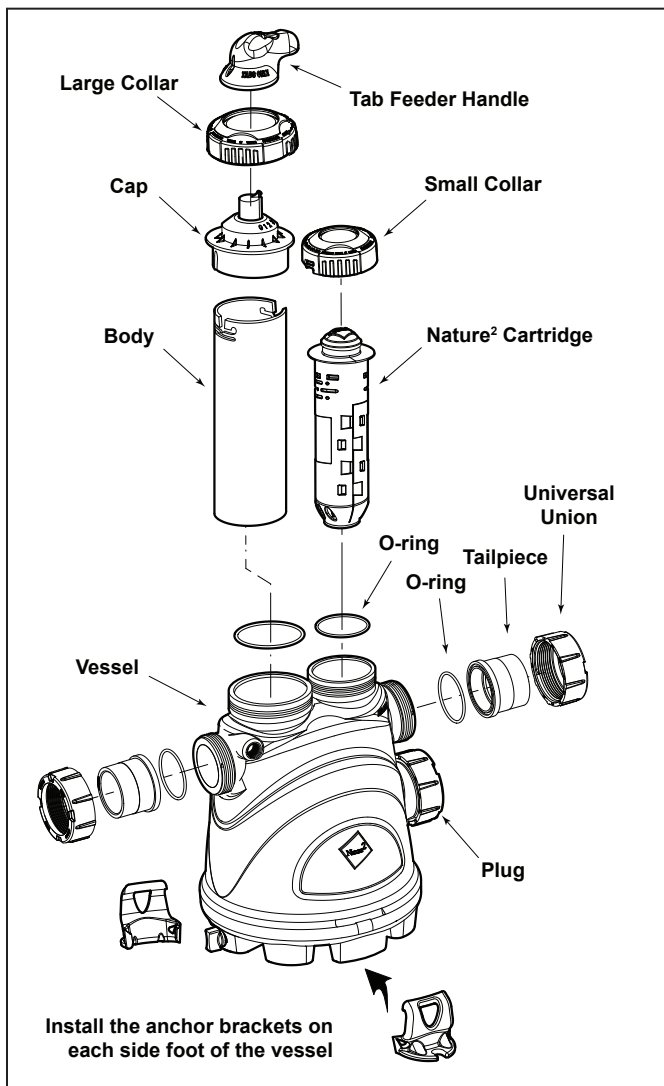

Figure 1. Nature2 Vessel Installation

3. Install the new vessel assembly and secure it with the hardware previously removed.
4. Make sure that the inlet and outlet ports are in their proper positions.
5. Reinstall the O-rings previously removed onto the inlet and outlet tail pieces of the vessel. Make sure the O-ring is seated properly and coated lightly with silicone lubricant. Hand tighten the universal unions to the vessel.

⚠ WARNING

Be careful not to get finger caught between inlet union and plug when tightening as this may cause an injury.

6. Reinstall the tab feeder assembly and Nature2 cartridge along with O-rings onto the vessel.
7. Reset valves and switches. Turn the pump and sanitizer on and check for leaks.
8. For operating instructions, please refer to the Nature2 Fusion Installation and Operation Manual, originally supplied with the product.

3. Parts List

The following table is for your reference. To order additional parts, please contact your local distributor.

DESCRIPTION	R0501600
Vessel Assembly	1
Anchors, Bracket	2
Instructions	1

